

# DENTAL PRODUCTS CATALOG



# Blue Dolphin Products



# Table of Contents

## Training and Education



Reference Guides	Page 2
Digital Training	Page 2
Visual Dictionary	Page 3
Tooth Study Models	Page 4
Dental Posters	Page 5
PTC TechBooks	Page 6
TechMaster Modules	Page 8

## CAD/CAM



Smile Libraries	Page 10
Scan Powder	Page 10

## Dental Office



Impression Trays	Page 11
------------------	---------

## Model and Die



Premium Model Preparation Products	Page 12
Crosspin Die Pinning System	Page 13
AdvanTech Model Prep	Page 15

## Crown and Bridge



Waxing Instruments	Page 16
Polishing Compound	Page 16
Dipping Wax	Page 17
Articulating Spray & Paper	Page 17
Wax Milling Blanks	Page 18
Carving Wax	Page 18

## Porcelain



Synthetic Brushes	Page 19
Porcelain Instruments	Page 20
Diamond Wheels	Page 21
Abrasive Points and Discs	Page 21
Carbide burs	Page 22
Greenstones	Page 22
Pressable Ingots	Page 23
Stain and Glaze	Page 24

## Dentures



Megatray System	Page 25
Articulators	Page 25
Denture Waxes	Page 26
Denture Molds	Page 26
Denture Instruments	Page 27
Measuring Instruments	Page 28
Denture Tools	Page 29
Ball Bearing Bite Recorder	Page 30
Denture Processing	Page 31

# Training and Education

## Standard Anatomy Reference Guide

This 19" x 14.5" laminated reference guide illustrates primary and secondary anatomy of the upper and lower Ness Teeth™. These durable laminated guides can protect the workbench and serve as an excellent tool for teaching and communicating dental anatomy. Illustrating the 10 components of a natural smile, this guide is the perfect start for establishing an esthetic standard in your laboratory.

Item# 203-2000 **\$19.95**  
 6+ **\$17.95**  
 12+ **\$14.95**

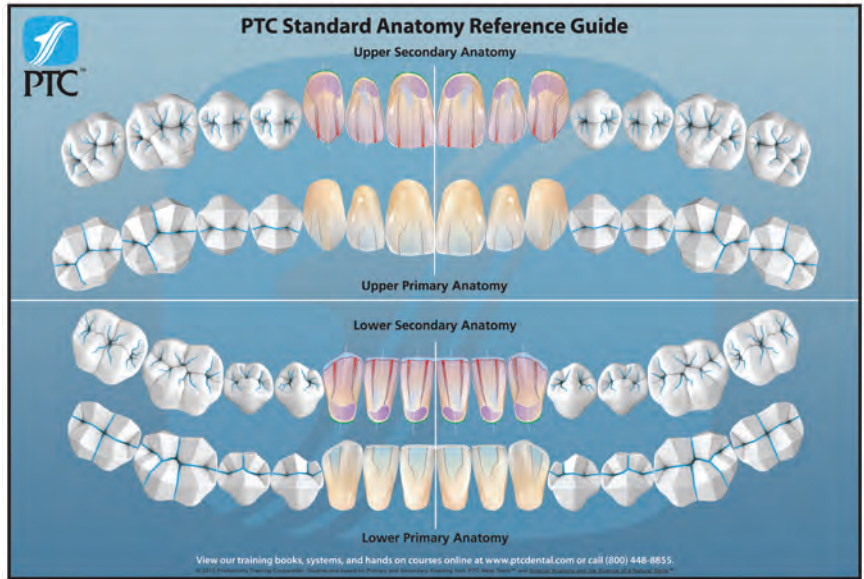

## Digital PTC Training for 3Shape and exocad

- More consistent results from different CAD designers
- Best way to teach CAD-savvy kids with no dental experience how to make designs that look like teeth
- The fastest way to retrain experienced dental technicians into the new world of CAD design

The PTC Training app is the only comprehensive CAD training program available for training in your laboratory. Now you can train inexperienced, computer-savvy people as well as not-so-computer-savvy, experienced technicians to design consistent digital crowns and bridges.

The PTC training apps not only teach how to use 3Shape and Exocad, they also incorporate proper crown and bridge anatomy and occlusion.



Download the **free** introductory app and receive the *Introduction to Computer Aided Design* course and our *Ness Visual Dictionary* of over 1500 illustrated dental terms **absolutely free!** Just search the Web for "PTC Training App".



**PTC 3Shape Training** 4 courses teach anatomy, 3Shape fundamentals, and posterior design **Item# 3SHAPE-CORE \$1400.00**  
**PTC exocad Training** 3 courses teach anatomy, exocad fundamentals, and posterior design **Item# EXOCAD-CORE \$1000.00**

# Ness Visual Dictionary OF DENTAL TECHNOLOGY

The **Ness Visual Dictionary** opens the doors to productivity, quality and consistency for every technician, lab and dental office. The answers are here. Put it on your desk now.

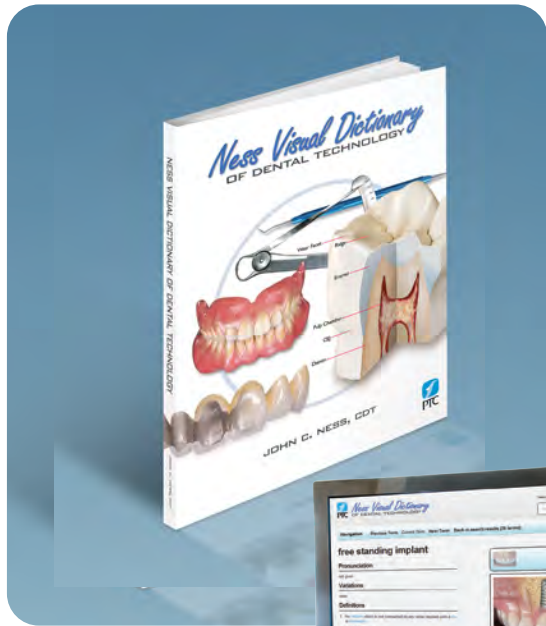

## Book

The spiral bound visual dictionary contains over 1450 essential dental terms that everyone, from dental students to dental assistants to dental technicians, would need to look up at a glance. In addition to definitions, dental terms contain full-color illustrations and a reference section including pronunciation, variations of a term, and a cross-reference to related terms.

Item# 203-1000 **\$119.00** **5+ \$99.00**

## Online

The online dental dictionary is fully searchable, and contains links to other dental terms used in a definition or reference. Users can quickly link from one related term to another for a thorough understanding of the subject. While the soft cover dictionary includes one image per term, each term in the online dictionary includes up to 6 images or illustrations.

With over 1,250 illustrations, the Ness Visual Dictionary is an indispensable training tool and reference for everyone in the dental industry.

- Over 1,450 terms
- 1,250 illustrations!
- 170 pages of know-how
- Just \$99

## Order

online: [www.bdpdental.com](http://www.bdpdental.com)  
phone: 800-448-8855



# Ness Teeth™

## Secondary Anatomy Comes Second.

When the proper cusps, slopes and ridges are formed in the primary anatomy, the natural contours and grooves of the secondary anatomy come easily. In the past, the only available study aids were sketches of primary anatomy planes. The Ness Teeth bring the third dimension to all the details of primary and secondary anatomy. Ness Teeth are a reference for the basics in full crown waxing, porcelain build-up, and porcelain contouring. Ness Teeth can help you make better quality restorations. Each tooth is ten times normal size. Ness Teeth are the tools a master technician will use every day.



### Posterior Ness Teeth™ Set

Now everyone can have a standard anatomical reference in their laboratory.

These 7 posterior Ness Teeth are the same size as our large standard teeth.

The new light weight polymer material is virtually indestructible, resistant to markings, and will not discolor with age.

Item# 205-3000 **\$199.00** (set of 7)



### Anterior Ness Teeth™ Set

These 3 anterior Ness Teeth are the same size as our large standard teeth.

The new light weight polymer material is virtually indestructible, resistant to markings, and will not discolor with age.

Item# 205-2000 **\$109.00** (set of 3)



### Ness Teeth™ Set

Consists of a set of 20 three dimensional models that show all the proper cusps and ridges in the primary anatomy and the natural contours and grooves in the secondary anatomy. Each tooth is ten times the normal size and is made of tough white epoxy that can be marked on and wiped clean. The full set of Ness Teeth consists of: 4 molars and 3 bicuspids in primary anatomy, plus 4 molars, 3 bicuspids, 2 cuspids and 4 anterior incisors in secondary anatomy.

Item# 205-1000 **\$579.95** (set of 20)

## NESS Plus<sup>+</sup>



### The New Standard of Excellence!

### Ness Plus™ Teeth Set

This set of naturally formed posterior teeth was hand waxed, carved and polished based on the work of famous German Master Dental Technician, Hans Puls. Each tooth's sulci are superbly rendered to help master ceramists build them precisely in wax or porcelain.

Item# 205-4000 **\$379.95** (set of 8)

# Dental Posters

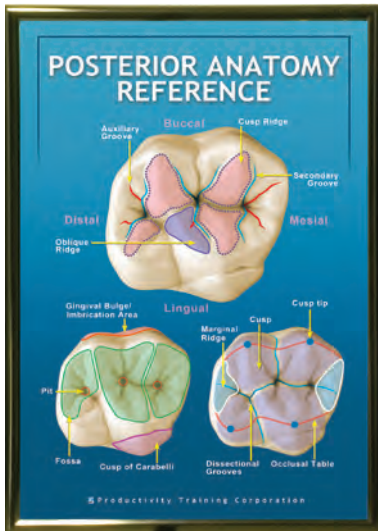

**Posterior Dental Anatomy**

Item# 200-9001

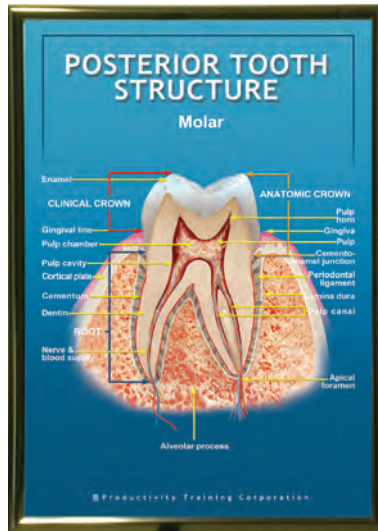

**Posterior Tooth Structure**

Item# 200-9002

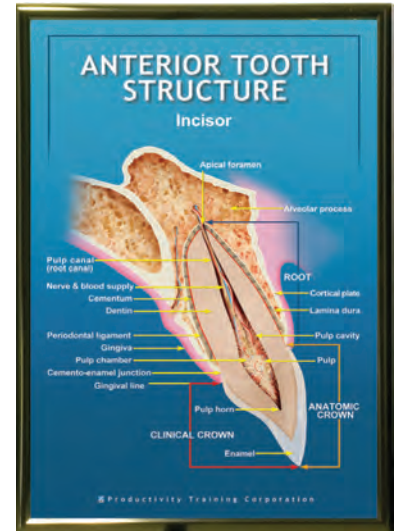

**Anterior Tooth Structure**

Item# 200-9003



**Anterior Teeth**

Item# 200-9004

Poster size is 20" x 30".

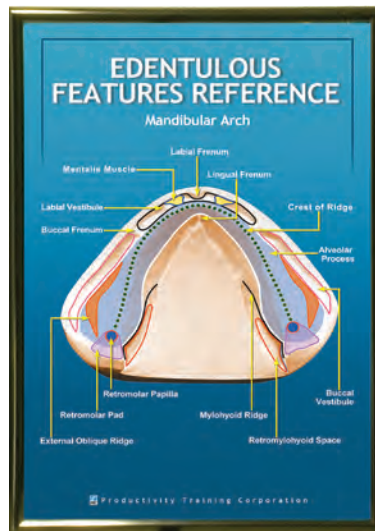

**Mandibular Arch Edentulous Features**

Item# 200-9005

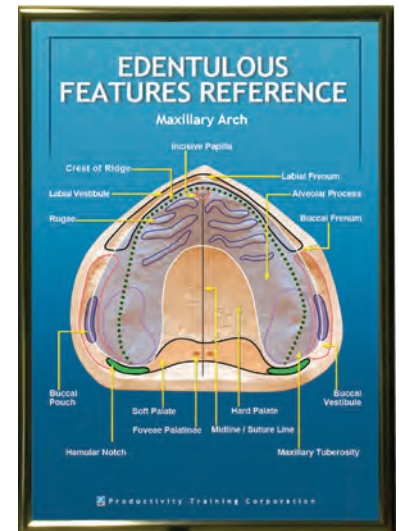

**Maxillary Arch Edentulous Features**

Item# 200-9006

**Single Poster (unframed)**

**\$49.20**

**Single Poster (framed)**

**\$76.95**

Acrylic frame with Plexiglass

**Set of all Six Posters (unframed)**

Item# 200-9007 **\$265.20**

**Set of all Six Posters (framed)**

Item# 200-9007F **\$420.70**

Acrylic frames with Plexiglass

ORDER ONLINE AT [WWW.BDPDENTAL.COM](http://WWW.BDPDENTAL.COM)

# PTC TechBooks and Digital Training

Your instant reference to the most efficient and effective dental laboratory production techniques.

## Simplifying Posterior Dental Anatomy

- Establish a stable anatomical reference and common vocabulary.
- The basis of all posterior restorations.
- A precise understanding of dental anatomy is the source of excellence in the dental laboratory.
- Essential to CAD/CAM design.

**English**

**Spanish** Simplificación Posterior Anatomía Dental

**German** Vereinfachte Seitenzahnanatomie

**Russian** Популярная анатомия боковых зубов

**Turkish** Arka Dişlerin Anatomisinin Basitleştirilmesi

Item# 200-8000 **\$159.00**

Item# 200-8001 **\$159.00**

Item# 200-8002 **\$159.00**

Item# 200-8003 **\$159.00**

Item# 200-8004 **\$159.00**

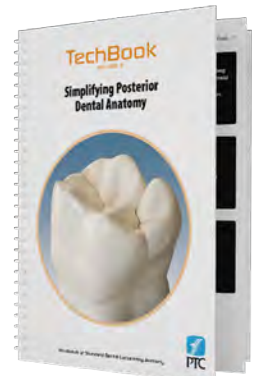

## Anterior Anatomy and the Science of a Natural Smile

- Dramatically improve your ability to communicate clearly with dentists, technicians, assistants and other dental professionals on the subject of esthetics.
- Learn the 10 essential components of natural smiles and understand how to use them to create customized smiles.
- Essential to all anterior restorations

**English**

**German** Frontzahnanatomie und die Wissenschaft eines natürlichen Lächelns

**Russian** Анатомия передних зубов и изучение принципов естественной улыбки

**Turkish** Ön Dişlerin Anatomisi ve Doğal Gülümsemenin Bilimi

Item# 200-7000 **\$199.00**

Item# 200-7002 **\$199.00**

Item# 200-7003 **\$199.00**

Item# 200-7004 **\$199.00**

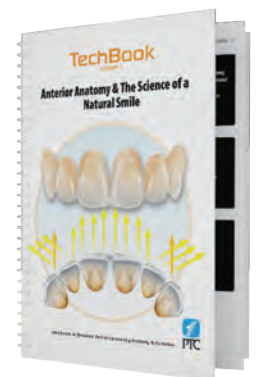

## Crown and Bridge Anatomical Waxing

- Based on the anatomical concepts learned in Simplifying Posterior Dental Anatomy.
- Learn PTC's clear, fast, and efficient step-by-step procedures for waxing posterior teeth to full contour.
- See specific examples of what the finished product should look like at the end of each step in wax.
- Each action is measured - eliminating any guesswork in your waxing skills.
- Streamline CAD/CAM design using these procedures.

**English**

**Russian** Моделирование из воска анатомической формы боковых зубов

**Turkish** Anatomik Kuron ve Köprü Modelajı

Item# 200-3000 **\$159.00**

Item# 200-3003 **\$159.00**

Item# 200-3004 **\$159.00**





## Framework Design and Fabrication

- Provides the essential information for framework design in wax, metal, and digital restorations.
- Proper framework design is the foundation for multiple unit restorations.
- Standard design principles apply universally to any material.

**English**

**Russian** Создание каркасов несъемных зубных протезов

**Turkish** Anatomik Kuron ve Köprü Modelajı

Item# 200-6000 **\$159.00**

Item# 200-6003 **\$159.00**

Item# 200-6004 **\$159.00**



## Anterior and Posterior Porcelain Application

- Learn a systematic method for opaquing and building both single-unit and multiple-unit anterior and posterior single crowns and bridges to increase both productivity and quality.
- Understand the importance of controlling body/enamel differentiation, opacious dentin and internal staining to create natural lifelike restorations.

**English**

**German** Schichtung von keramischen Front- und Seitenzahn- Kronen und -Brücken

**Russian** Нанесение керамической массы. Передние и боковые мостовидные протезы

**Turkish** Ön ve Arka Dişlerde Porselen Uygulamaları

Item# 200-1000 **\$199.00**

Item# 200-1002 **\$199.00**

Item# 200-1003 **\$199.00**

Item# 200-1004 **\$199.00**

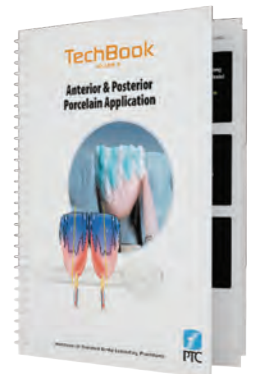

## Contouring Anterior Bridges

- Utilize PTC's precise step-by-step procedures for creating anatomically correct and esthetically pleasing anterior restorations, time after time.
- Discover how aligning all of the anatomical features of anterior teeth with the long axis of the tooth is essential in creating natural looking restorations.
- These procedures are the fastest way to learn anterior contouring.
- Anterior Anatomy and The Science of a Natural Smile supports these concepts and procedures.

**English**

**German** Herstellung von Frontzahnbrücken

**Russian** Контурирование передних мостовидных протезов

**Turkish** Ön ve Arka Dişlerde Porselen Uygulamaları

Item# 200-2000 **\$159.00**

Item# 200-2002 **\$159.00**

Item# 200-2003 **\$159.00**

Item# 200-2004 **\$159.00**

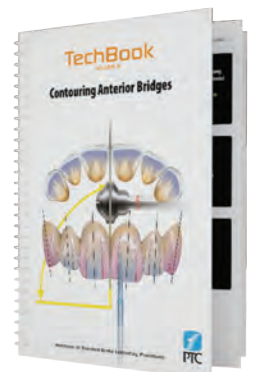

## Pricing Discounts

Buy 3 books **10% discount**

Buy complete set (8) **15% discount**

## Contouring Posterior Bridges

- Learn a systematic procedure for contouring posterior bridges.
- Each action is pre determined by using model landmarks and measured markings.
- Combined with the knowledge learned in Simplifying Posterior Dental Anatomy you will find contouring beautiful anatomical ceramics crowns is easier than you ever imagined.
- Regardless of your experience, these procedures can increase your consistency and productivity.

**English**

**Russian** Контурирование боковых мостовидных протезов

**Turkish** Arka Bölge Köprülerin Şekillendirilmesi

Item# 200-4000 **\$159.00**

Item# 200-4003 **\$159.00**

Item# 200-4004 **\$159.00**

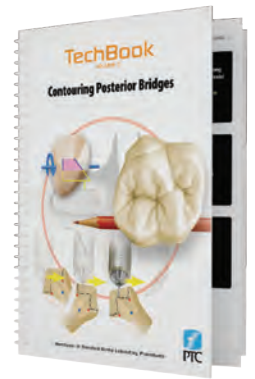

## Creating Natural Dentures

- Learn the muscles, attachments, and anatomical features necessary to create a stable denture.
- Discover how simple measuring instruments can quickly provide accurate guidelines for technicians to follow when constructing natural, self-cleaning, premium dentures.
- Develop the ability to quickly set anterior and posterior teeth and make subtle adjustments for strong or soft esthetic compositions.

**English**

**Russian** Создание биофункциональных протезов

**Turkish** Doğal Protez Yapımı

Item# 200-5000 **\$199.00**

Item# 200-5003 **\$199.00**

Item# 200-5004 **\$199.00**

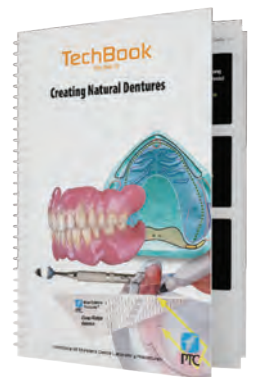

# PTC TechMaster Modules

Each module includes an illustrated step by step manual with corresponding training DVDs. A combined manual and workbook that guides you step by step through the learning process. Using the proven PTC knowledge transfer techniques, the TechGuide prompts when to read the manual, watch the training DVD, study the learning drills and complete the exercises.



**Simplifying Posterior Dental Anatomy TechMaster Module (1 DVD)**

Learning posterior anatomy has never been easier. This DVD/Book module is the foundation all dental technicians must have to build a rock solid career.

Item# 202-8000 **\$574.00**

**TechMaster Addons: Set of 7 Posterior Ness Teeth + \$199.00**

**Anterior Anatomy and The Science of a Natural Smile TechMaster Module (1 DVD)**

Covering anterior anatomy as you have never seen before, learn the 10 fundamental concepts that will take your ceramic restorations to the next level.

Item# 202-7000 **\$624.00**

**TechMaster Addons: Set of 3 Anterior Ness Teeth + \$109.00**

**Crown and Bridge Anatomical Waxing TechMaster Module (1 DVD)**

Condensed and simplified, learn exactly what to do to make stunning, anatomically correct, full contour waxups.

Item# 202-3000 **\$574.00**

**TechMaster Addons: Set of 7 Posterior Ness Teeth + \$199.00**

**Waxing Student Kit + \$115.00**

**Framework Design and Fabrication TechMaster Module (1 DVD)**

Covering skills from consistently perfect margins, pontic placement and design, maximizing connector strength, to designing frameworks to avoid multiple porcelain firings, this module sets the stage for the entire porcelain department.

Item# 202-6000 **\$574.00**

**TechMaster Addons: Set of 7 Posterior Ness Teeth + \$199.00**

**Waxing Student Kit + \$115.00**

**Anterior and Posterior Application TechMaster Module (2 DVDs)**

Covering the A to Z of how to build a bridge or single unit, start your training off or improve your existing skills.

Item# 202-1000 **\$999.00**

**TechMaster Addons: Set of 3 Anterior Ness Teeth + \$109.00**

**Set of 7 Posterior Ness Teeth + \$199.00**

**Ceramic Building Student Kit + \$189.00**

**Contouring Anterior Bridges TechMaster Module (1 DVD)**

The contouring Anterior Bridges module, paired with Anterior Anatomy and The Science of a Natural Smile takes the mystery out of anterior restoration.

Item# 202-2000 **\$574.00**

**TechMaster Addons: Set of 3 Anterior NessTeeth + \$199.00**

**Anterior Contouring Student Kit + \$149.00**

**Contouring Posterior Bridges TechMaster Module (1 DVD)**

Using model landmarks and measured markings, each contouring action is pre-determined, giving you the easiest and most streamlined procedure for contouring beautiful ceramic crowns.

Item# 202-4000 **\$574.00**

**TechMaster Addons: Set of 7 Posterior NessTeeth + \$199.00**

**Posterior Contouring Student Kit + \$149.00**

**Creating Natural Dentures TechMaster Module (4 DVDs)**

One of our most comprehensive modules- learn the skills and exact steps for producing self-cleaning, esthetic, natural looking dentures.

Item# 202-5000 **\$1,974.00**

**TechMaster Addons: Denture Student Kit + \$199.00**

# CAD/CAM

## The PTC Triple A° Smile Libraries

- Based on our extremely popular Ness Teeth™ training models
- 5 libraries based on different stages of wear

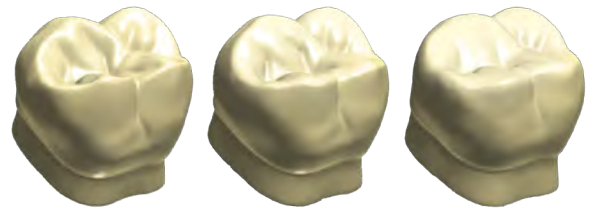

With the PTC Triple A° smile libraries, it's simple and quick to pick the library that best matches the wear of the patient's teeth. Instead of featureless shapes, restored teeth match the wear of the adjacent teeth while retaining all the anatomical features of natural dentition.

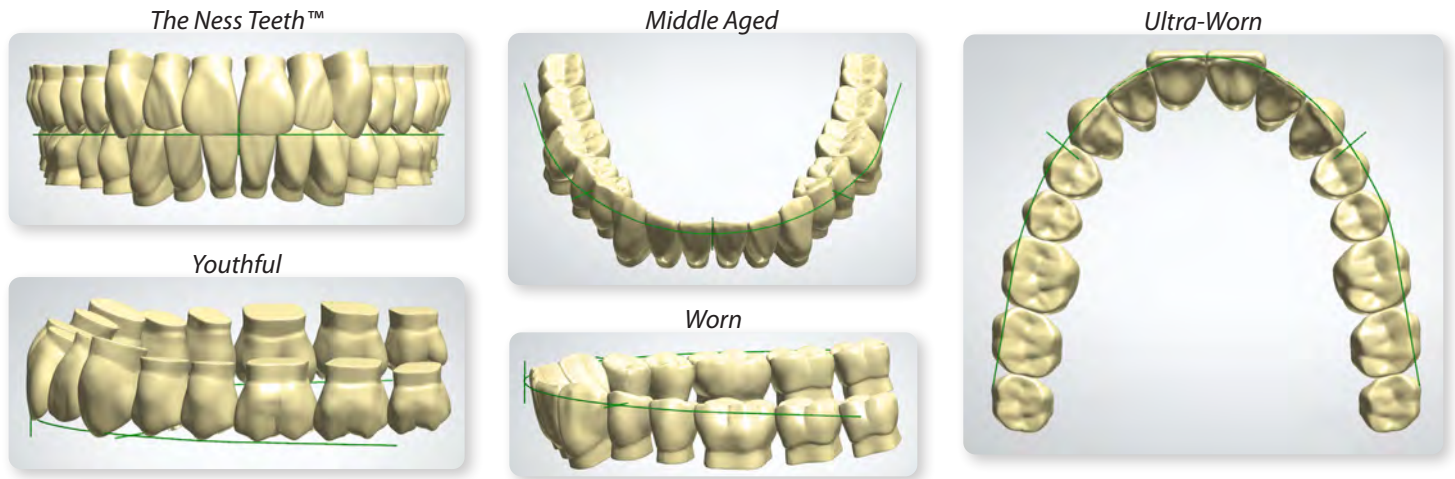

**PTC Triple A° Smile Libraries** 5 libraries of anterior and posterior teeth in 5 stages of wear **Item# PTC-AAA \$495.00**

## CAD/CAM Scanning Powder

Snow Scan Powder is a new alternative to scan spray for CAD/CAM. It is up to 12x more accurate with a 1µm coating, compared to spray's average coating of 12µm. Scan Powder yields over 3000 abutment scans per container, compared to just 50 scans per spray can. It leaves a perfectly even coating, has no dry wait time, and is easy to clean up. The dust-like powder adheres to metal, wax, zirconia, stone, resin, and other shiny surfaces.

# SNOW SCAN POWDER



Powder vs. Spray Comparison

	Snow Scan Powder 10g	Scan Spray Type 72ml
Accuracy	1µ	12µ
Usage	3,000 abutments	50-60 abutments

- Sticks to anything and everything! (metal, wax, zirconia, stone, and resin)
- More accurate than spray
- More economical than spray
- Super thin, precise, and even coating
- Easy application and clean up

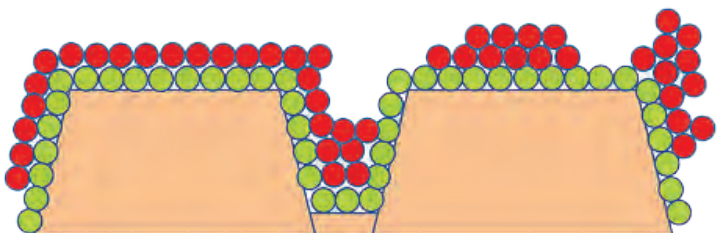

Snow Scan Powder (green) leaves a perfectly even layer  
Conventional spray (red) creates build up and uneven layers

**Snow Scan Powder** **Item# SP2101A \$149.00**

# Dental Office

## Transform Heat-Mouldable Impression Trays



**Transform™**

- Enhanced anatomical shape
- Strong and disposable
- Good retention slots
- Heat mouldable



Three heat-mouldable sizes and separate designs for dentate and edentulous patients require much less impression material, resulting in less shrinkage and superior fitting restorations.

<b>A Dentate - Large Lower</b> (12 pcs)	Item# 400-202	<b>\$9.49</b>
<b>B Dentate - Large Upper</b> (12 pcs)	Item# 400-203	<b>\$9.49</b>
<b>C Dentate - Medium Lower</b> (12 pcs)	Item# 400-204	<b>\$9.49</b>
<b>D Dentate - Medium Upper</b> (12 pcs)	Item# 400-205	<b>\$9.49</b>
<b>E Dentate - Small Lower</b> (12 pcs)	Item# 400-206	<b>\$9.49</b>
<b>F Dentate - Small Upper</b> (12 pcs)	Item# 400-207	<b>\$9.49</b>
<b>G Edentulous - Large Lower</b> (12 pcs)	Item# 400-208	<b>\$9.49</b>
<b>H Edentulous - Large Upper</b> (12 pcs)	Item# 400-209	<b>\$9.49</b>
<b>I Edentulous - Medium Lower</b> (12 pcs)	Item# 400-211	<b>\$9.49</b>
<b>J Edentulous - Medium Upper</b> (12 pcs)	Item# 400-212	<b>\$9.49</b>
<b>K Edentulous - Small Lower</b> (12 pcs)	Item# 400-213	<b>\$9.49</b>
<b>L Edentulous - Small Upper</b> (12 pcs)	Item# 400-214	<b>\$9.49</b>
<b>Edentulous - Mixed Bag</b> (12 pcs)	Item# 400-200	<b>\$9.89</b>
<b>Dentate - Mixed Bag</b> (12 pcs)	Item# 400-201	<b>\$9.89</b>



**HEAT MOULDABLE IMPRESSION TRAYS**

A custom shape: created by you

**Quick and Simple**  
Can be moulded with hot water in less than 60 seconds at chairside

# Model and Die

## PTC Premium Model Preparation Products



### PTC Stone Separator™

Insulates stone from stone without forming a film. Includes 1 Liter bottle with spray applicator.

Item# 600-100 **\$55.35**

### PTC Bubble-Free™

Guarantees bubble free and smooth pouring of investment materials. Includes 1 Liter bottle with spray applicator.

Item# 600-101 **\$41.49**

### PTC Die Lube™

For easy removal of wax patterns. (40 ml bottle).

Item# 600-102 **\$23.69**

### PTC Die Hard™

Hardens and protects stone die and models without leaving a film. (40 ml bottle).

Item# 600-103 **\$27.79**

### PTC Die Hard Thinner™

Use to maintain original viscosity of Die-Hard™ Stone Protectant.

Item# 600-104 **\$20.59**



### PTC Die Spacers

Fast drying die spacer. Resistant to all die lubricants. Provides a very hard smooth surface. (20 ml. bottle).

**Gold Die Spacer - Item# 600-106 \$21.59**

**Silver Die Spacer - Item# 600-107 \$21.59**

**Die Spacer Thinner - Item# 600-105 \$19.49**



### PTC Die Hardener Kit

Includes:

40 ml Die-Hard™

40 ml Die-Hard™ Thinner

Item# 600-108 **\$44.29**



### PTC Die Spacer Kit

Includes:

20 ml Silver or Gold Die Spacer

20 ml Silver-Thin™

Item# 600-109G **\$37.99**

Item# 600-109S **\$37.99**



### PTC Die Prep Kit

Includes:

40 ml Die-Hard™

20 ml Silver or Gold Die Spacer

40 ml Die Lube™

Item# 600-110G **\$65.99**

Item# 600-110S **\$65.99**



## Die Pinning System

The Crosspin system consists of a unique dowel pin and sleeve design, low profile model former and matching drill bit. Crosspins are precisely engineered for simplicity, stability and ease of use. The low-profile model can save 32% in base stone material cost while the single pin design speeds production.

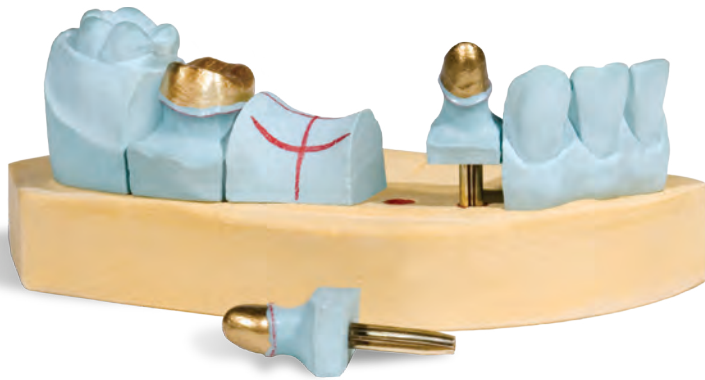

Precisely engineered for **stability** and **ease of use**.

## Crosspin Features

### Mix and Match Sizes

Four combinations of pins and sleeves adapt to individual preference.

### Straight Pin & Sleeve

Does not trap debris like tapered pins

### Single Pin System

Ideal for anterior use  
Reduces production time and material costs by using fewer pins

### Unique "+" Profile

Extremely stable  
Prevents rotation  
Maintains stability when raising the die is required

### Matching Drill Bit

Fully compatible with Pindex drill

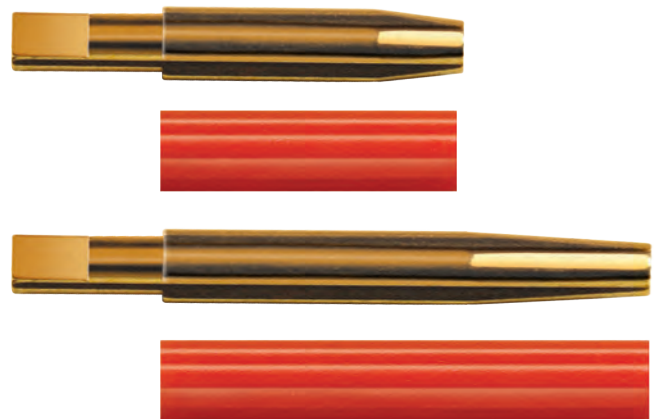

# Starter Kits



Want to try the Crosspin System? Our Starter Kits come complete with everything you need to really test the precision, stability and retention of Crosspins.

## Crosspin Intro Kit (Short)

15mm Short Pins & Sleeves (200 Count), (1) Drill Bit, (2) Quadrant Model Formers & (1) Full Model Former.

Item# 500-100 **\$58.84**

## Crosspin Intro Kit (Short & Long)

22mm Long Pins & Sleeves (100 Count), 15mm Short Pins & Sleeves (100 Count), (1) Drill Bit, (2) Quadrant Model Formers & (1) Full Model Former.

Item# 500-101 **\$58.84**

# Accessories

Our Crosspin Drill Bit and Model Formers are specially designed for the Crosspin Model and Die Pinning System.

## Crosspin Drill Bit

Item# 500-130 **\$38.45**



## Crosspin Model Former (Quadrant)

Twelve (12) Quadrant Formers for use with Short Pins only.

Item# 500-145 **\$37.10**

## Crosspin Model Former (Full Arch)

Six (6) Full Arch Formers for use with Short Pins only.

Item# 500-140 **\$37.10**



# Crosspin Refills

### Pins with Sleeves:

Long pins w/ long sleeves (1000 each) Item# 500-150

Short pins w/ short sleeves (1000 each) Item# 500-110

Long pins w/ short sleeves (1000 each) Item# 500-170

Short pins w/ long sleeves (1000 each) Item# 500-171

**\$149.46 6+ \$134.51**

### Only pins or sleeves:

Long pins (1000 count) Item# 500-160 **\$88.47**

Short pins (1000 count) Item# 500-175 **\$88.47**

Long sleeves (1000 count) Item# 500-165 **\$76.10**

Short sleeves (1000 count) Item# 500-180 **\$76.10**





## Advantech Die Lubricant

Developed using advanced micro-film technology, Advantech™ Die Lubricant offers a non-oily, clean and residue free release of dipped wax copings or hand applied wax without pattern distortion. Permits close adaptation to the die for greater accuracy of the casting. Use on all materials where wax separation is required, including stone, epoxy, polyurethane, and metal. (1 oz).

Item# 601-100 **\$23.69**

## Advantech Die Spacers

Exhibiting smooth feel and flow, the Advantech series of fast drying die spacers and sealers are characterized by superb thixotropic consistency, uniform homogeneous layer thickness, and outstanding resistance against pressurized steam, scratching and chipping. Fast 15-second set time between coats. (1 oz).

**Gold Die Spacer** - Item# 601-102 **\$20.59**

**Silver Die Spacer** - Item# 601-103 **\$20.59**

**Die Spacer Thinner** - Item# 601-101 **\$20.59**

## Advantech Die Sealer

A paint-on acrylic resin for sealing and hardening stone dies and models. Water proofs and seals stone surface without layer build-up on the die. Protects margins and reduces abrasion. Individual consistency controlled by using Advantech™ Thinner. (1 oz).

**Die Sealer** - Item# 601-104 **\$20.59**

**Die Sealer Thinner** - Item# 601-105 **\$20.59**

## Advantech Dental Glue

Recommended for cementing dowel pins into models, gluing plasterless articulators, sealing models and dies, protecting margins, and hardening model surfaces. In addition, the formulation can also be used to temporarily repair loose or broken denture teeth and fractured models. A precision applicator allows for precise placement of material with minimal waste.

Item# 602-100 **\$11.29**

# Crown and Bridge

## Waxing Instruments



### WC-1™ Waxing Instrument

The 1.5 mm discoid end is ideal for carving perfect margins and interproximal areas on wax frameworks. The 1/2 Hollenback end is designed for carving full anatomical crowns and all other carving procedures.

Item# 105-101 **\$39.99** 6+ **\$35.99**



### WC-2™ Waxing Instrument

**#1 Best Selling Instrument**

The cone shaped end can be used to smooth the dissectional, secondary and auxiliary grooves in occlusal surfaces of full crowns. It's perfect for shaping interdental papillae and gingival contours on full denture waxups. The opposing end is a spatula used for carrying molten wax.

Item# 105-102 **\$39.99** 6+ **\$35.99**



### Waxing Instrument Set

Includes (1) WC-1 and (1) WC-2

Item# 105-100 **\$74.10**



## Polishing Compound

### White Lightning

Europe's best selling compound, White Lightning's creamy consistency enables it to cling to the material, resulting in a faster, more effective polish. Perfect for polishing both precious and non precious metals as well as acrylic and composites. (300 grams).

Item# 401-100 **\$31.85** 6+ **\$28.86**



## Dipping Wax

### Perfect Margin Dipping Wax

This durable wax is highly plasticized and adapts perfectly to the die to create an even coat of wax that is semi-transparent so you can easily see the margin. This wax has a high melting point that prevents distortion during the application of carving wax and can be burnished easily without tearing or thinning at the margin. No additional margin wax needed.

Available in grey only.

**6 oz bag** - Item# 700-100 **\$44.95** 6+ **\$40.45**

**12 oz bag** - Item# 700-101 **\$75.59** 6+ **\$68.03**



## Articulating Spray

### Micro-Thin Articulating Spray

Micro-Thin Articulating Spray facilitates the perfect fitting of all crowns, bridges and precision attachments. Available in colors listed below. (75 ml bottle)

**Green** Item# 800-100 **\$19.49**

**Blue** Item# 800-101 **\$19.49**

**Red** Item# 800-102 **\$19.49**

**White** Item# 800-103 **\$19.49**



## BDP Articulating Paper

Double sided red/blue 65 micron Articulating Paper is used for accurate discrimination between occlusal contacts. The horseshoe shape provides simultaneous bilateral markings to disclose traumatic prematurities of up to .010".

Item# 800-104 **\$3.97** 6+ **\$3.69**



### Perfect Margin Kit

Contains everything you need to create perfect margins.

Perfect Margin Dipping Wax (6 oz)

Die Lube (30 ml)

Die Sealer (30ml)

Gold or Silver Die Spacer (20 ml)

Waxing Instrument WC-1

The PTC Perfect Margin Procedure

Item# 700-102 **\$130.61**

## Radar™ Articulating Paper

### Horseshoe or Curved

At only 40 microns thick, this thin Swiss-made paper ensures highly precise bite markings on all materials, wet or dry.

Radar Articulating Paper gives dentists and lab techs the precision of film and foil with the ease-of-handling of thicker papers. Red and blue sides may be used alternately to check the same arch.

**Horseshoe** (6 bundles) Item# 800-105 **\$17.45** 6+ **\$16.23**

**Curved** (12 bundles) Item# 800-106 **\$15.49** 6+ **\$14.44**



# Aesthetic Press Wax Blanks



## Vanilla SPEED Wax Blank, 98 mm

This new formula of wax enables the same easy modification as our original Vanilla Blank with fast, accurate milling capability.

For a fast mill you can work with, try our new 20,000 RPM Vanilla SPEED!

- 98 x 12 mm Item# 49580 **\$23.99**
- 98 x 14 mm Item# 49581 **\$23.99**
- 98 x 16mm Item# 49582 **\$23.99**
- 98 x 18 mm Item# 49583 **\$23.99**
- 98 x 20 mm Item# 49584 **\$23.99**
- 98 x 25 mm Item# 49585 **\$23.99**
- 98 x 30 mm Item# 49586 **\$23.99**

## White Lemon Wax Blank, 98 mm

A beautiful white wax blank perfect for diagnostic wax ups. Fresh lemon scent and easy to work with.

- 98 x 12mm Item# 49568 **\$23.99**
- 98 x 14mm Item# 49569 **\$23.99**
- 98 x 16mm Item# 49570 **\$23.99**
- 98 x 18mm Item# 49571 **\$23.99**
- 98 x 20mm Item# 49572 **\$23.99**



# Advantech Diagnostic Waxes

A mounted Diagnostic Wax-up is a critical roadmap to planning a realistic result.

Advantech Diagnostic waxes are available in Vita shades A, B, C, D, and white. These waxes give crown and bridge waxers and ceramists the tools needed to create realistic diagnostic wax-ups that help doctors increase the approval rate and patient satisfaction for their intended treatments.

Easily carvable with comparable characteristics of our carving waxes allow for clean, sharp carving and effortless polishing to a smooth high sheen.



60 gram container.

- Advantech Diagnostic Wax Shade A Item# 700-106 **\$37.79**
- Advantech Diagnostic Wax Shade B Item# 700-107 **\$37.79**
- Advantech Diagnostic Wax Shade C Item# 700-108 **\$37.79**
- Advantech Diagnostic Wax Shade D Item# 700-109 **\$37.79**
- Advantech Diagnostic Wax White Item# 700-110 **\$37.79**

## Advantech Sculpturing Wax

Hard, but not brittle, this wax carves smoothly and evenly. Because of its unique properties, technicians can carve primary and secondary anatomy with no distortion or wax break-up. As a result, full cast crowns can have the same anatomical features as porcelain to metal crowns - a further reinforcement of your laboratory standard. The pleasing yellow color makes critical contour angles and fine secondary anatomy easily visible.

Advantech Sculpturing Wax is ash-free and burns out cleanly. 60 gram container.

Item# 700-111 **\$37.79**



# Porcelain

## Synthetic Porcelain Brushes



### Cusp/Lobe Application Brush

Used for general porcelain application on single units and small bridges.

Item# 104-111 **\$9.97** 6+ **\$8.97**



### Rapid Building Brush

Provides proper moisture for building multiple unit cases. Synthetic materials provide a firm tip for sculpting.

Item# 104-112 **\$9.97** 6+ **\$8.99**



### Internal Effects Brush

Used to apply internal modifiers and stains.

Item# 104-114 **\$9.69** 6+ **\$8.72**



### External Effects Brush

This brush is used for fine line characterization and general staining.

Item# 104-115 **\$9.69** 6+ **\$8.72**



### Primary Plane Brush

This stiff brush is used to contour and shape soft porcelain on anterior and posterior buildups.

Item# 104-117 **\$11.29** 6+ **\$10.16**



### Finishing Brush

Used for final smoothing and condensing of wet porcelain.

Item# 104-116 **\$12.29** 6+ **\$11.06**



### Model Duster

Used for general model clean up and smoothing full contour wax ups.

Item# 104-113 **\$9.97** 6+ **\$8.97**



### Synthetic Porcelain Brush Set

Contains one of each of the seven synthetic porcelain brushes. Great for trying out new brushes for the technician that is looking for the perfect brush.

Item# 104-118 **\$69.79**



# Porcelain Instruments

## #3 Carver

Designed for carving anatomy on all surfaces, works extremely well when carving the lingual surface of anterior teeth. Also is a vital tool for carving precise depressions in porcelain for application of modifiers.



Item# 104-103 **\$26.79** 6+ **\$24.11**

## Characterizer/Explorer

Two in one tool used for the creation of crack lines and other subtle internal enamel features in soft porcelain. The curved end is used for carving secondary anatomy and very fine depressions for internal color effects. Useful for carving fine detail in wax.



Item# 104-104 **\$32.19** 6+ **\$28.97**

## Probe

The tip is marked with three grooves: 1 mm, 2 mm & 3 mm for measuring the thickness of porcelain. Saves time and enhances aesthetics as it ensures a more accurate build-up.



Item# 104-105 **\$26.79** 6+ **\$24.15**

## Slicer

The ultra thin stainless steel blade is used for fast contouring of body and enamel build up.



Item# 104-106 **\$26.79** 6+ **\$24.15**

## Porcelain Instrument Set

Contains one of each of the Porcelain Instruments.

Item# 104-100 **\$104.44**

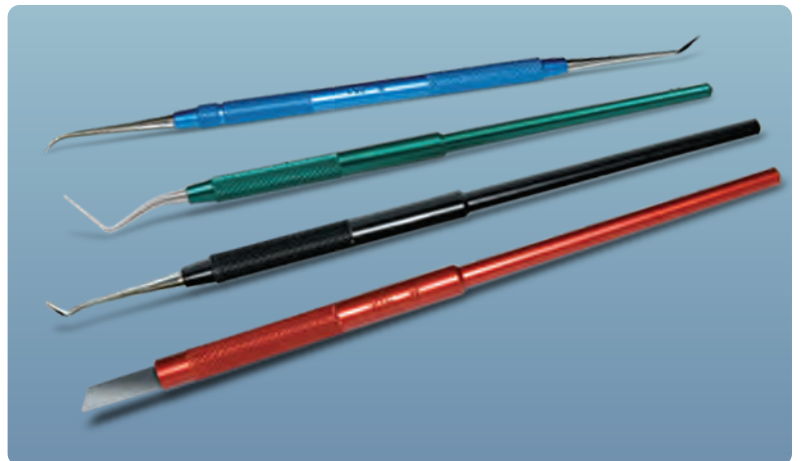

# Abrasives, Diamonds, Diamond Wheels, Discs, and Points

## PTC Anterior Diamond Wheel

This wheel has slightly rounded edges designed to create softened contours on labial surfaces of anterior teeth. The diamond surface prevents chipping of delicate incisal edges.

Item# 106-310 **\$24.89** 6+ **\$22.40**

## PTC Posterior Diamond Wheel

This wheel is slightly more aggressive than the anterior wheel. The square edge allows consistent, predictable contouring of posterior contours and contacts.

Item# 106-320 **\$24.89** 6+ **\$22.40**

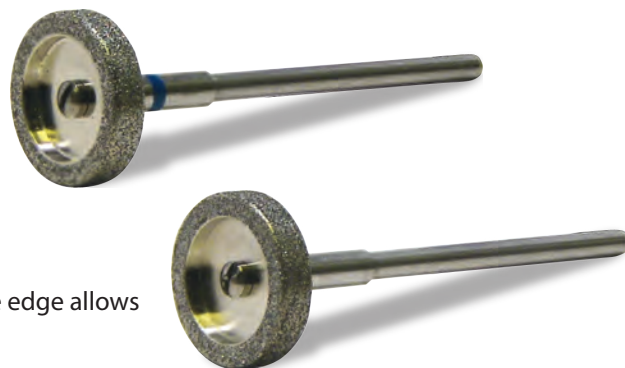

**The Anterior & Posterior Diamond Wheels are the tools of choice for contouring ceramics.**

## Speedy Separating Discs

These aggressive discs can be used on metal or porcelain. They are most useful as cut off discs as well as interproximal reduction of porcelain bridges. (Box of 100)

Item# 106-170 **\$34.89** 6+ **\$31.40**



## SIDIA Sintered Diamond Disc

This extremely long lasting and high quality sintered diamond disc is only 0.15 mm thick, yet rigid enough to define the interproximal separations without bending or distorting. The disc features a 3mm pure sintered diamond edge that prevents black lines.

Item# 106-300 **\$59.49** 6+ **\$53.54**



## D-201 Diamond Disc

0.2 mm flexible disc can be used for cutting and shaping porcelain interproximals. It is stiff enough to resist permanent distortion with use, yet flexible enough to soften the interproximal line angles, which create a natural-looking effect in porcelain work. Diamond layered on one side only.

Item# 104-400 **\$16.49** 6+ **\$14.84**

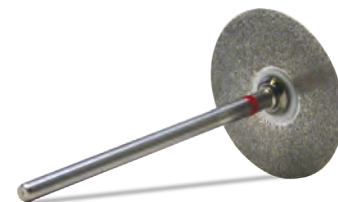

## Ultra-Thin Diamond Disc

Ultra thin diamond disk for precision contouring of interproximal and incisal embrasures.

Item# 104-401 **\$21.39**

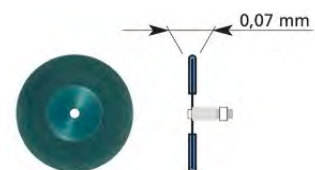

## T-101 Tapered Diamond

Used specifically to blend the contoured areas of anterior and posterior crowns and bridges. The medium grit diamond quickly blends rough contoured areas of porcelain with very little effort. The fine grit T-101 is ideal for texturing all contoured surfaces.

**Blue Band T-101 Tapered Diamond (Medium)** - Item# 106-110 **\$9.95** 6+ **\$9.45**

**Red Band T-101 Tapered Diamond (Fine)** - Item# 106-115 **\$9.95** 6+ **\$9.45**



### Paraboidal Cingulum Refiner

This small cone shaped diamond is ideal for quickly enhancing the cingulum and lingual concavity of anteriors.



**Paraboidal Cingulum Refiner (Medium) - Item# 106-105 \$9.95**

**Paraboidal Cingulum Refiner (Fine) - Item# 106-100 \$9.95**

### Cylindrical Fossae Enhancer

The barrel diamond shape is perfect for refining occlusal primary planes on posterior teeth.



**Cylindrical Fossae Enhancer (Medium) - Item# 106-120 \$9.95 6+ \$9.25**

**Cylindrical Fossae Enhancer (Fine) - Item# 106-125 \$9.95 6+ \$9.25**

### FG Carbide Burs

**#37 Carbide Burs** Can be used for occlusal carving of developmental grooves on ceramic restorations. Pack of 10.

Item# 106-150 **\$14.85**



**#35 Carbide Burs** Used for more delicate ceramic carving such as secondary grooves and crack lines. Pack of 10.

Item# 106-151 **\$14.85**

## Greenstones

Designed to easily produce the anatomical contours and delicate surface textures that duplicate the anatomical features of natural teeth. Our Master Series Greenstones enable you to contour your work rapidly and efficiently while still leaving a smooth surface. These stones are just the right hardness to contour effectively, but still retain their shape. **Sold in boxes of 12.**

#### S-301/IC-5 Large Inverted Cone

Cusp contouring, general occlusal anatomy, imbrication lines, lingual areas. Can be used for small areas and anatomical features. 5 mm diameter.



Item# 106-131 **\$17.27 6+ \$15.54**

#### S-303/WH-6 Large Square Edge Wheel

General use and bulk reduction, incisal 1/3 facets. Used to create labial, buccal and lingual contours of crowns and bridges.



Item# 106-133 **\$17.27 6+ \$15.54**

#### S-305/IC-7 Large Inverted Cup

Cusp contouring, contact points, bulk contouring of posterior primary anatomy.



Item# 106-135 **\$17.27 6+ \$15.54**

#### S-307/KN-7 Knife Edge Wheel

Shaping interproximal areas, contouring bulk porcelain and porcelain metal junction.



Item# 106-137 **\$17.27 6+ \$15.54**

#### S-309/TC-4 Large Tapered Cylinder Flat End

General contouring, definition of shoulder areas and porcelain to zirconia junctions.



Item# 106-139 **\$17.27 6+ \$15.54**

#### S-311/TC-1 Small Tapered Cylinder Flat End

Fine contouring and occlusal anatomy.



Item# 106-141 **\$17.27 6+ \$15.54**

#### S-313/IC-3 Small Inverted Cone

Occlusal anatomy, creating striations, and imbrication lines. 3 mm diameter.



Item# 106-143 **\$17.27 6+ \$15.54**

#### S-315/FL-2 Flame

Contouring concave areas, linguals of anteriors.



Item# 106-145 **\$17.27 6+ \$15.54**

#### S-317/WH-4 Small Square Edge Wheel

Overall shaping and grinding, developmental groove areas and incisal edge facets.



Item# 106-147 **\$17.27 6+ \$15.54**





# Press Ingots for Single Crowns, Veneers and Inlays/Onlays



## Press & Stain Ingots

For the press & stain technique, the technician can achieve the entire color spectrum with 3 different value based ingots. With one stain cycle, light colors as well as the dark shades can be matched without the use of glaze paste. The silicate-reinforced porcelain ensures a higher strength.

The APVolution Z Light covers the lighter shades ranging from A1-A2, B1-B2, C1-C2, or D2, whereas the APVolution Z Dark ingot is good for shades A3-A3.5. The APVolution Z Dark Plus ingot covers the A4, B4, C4, D4 range.

Ingot	2g #	Price	3g #	Price
<b>AP Volution Z Light</b>	41202	<b>\$101.59</b>	41203	<b>\$129.34</b>
<b>AP Volution Z Dark</b>	41204	<b>\$101.59</b>	41205	<b>\$129.34</b>
<b>AP Volution Z Dark Plus</b>	41211	<b>\$101.59</b>	41212	<b>\$129.34</b>
<b>AP Volution Z Bleach 1</b>	43022	<b>\$101.59</b>	43023	<b>\$129.34</b>
<b>AP Volution Z Bleach 2</b>	49834	<b>\$101.59</b>	49839	<b>\$129.34</b>
<b>AP Volution Z Bleach 3</b>	43024	<b>\$101.59</b>	43025	<b>\$129.34</b>

## Press & Layer Ingots

The Aesthetic-Press dentin ingots are designed for anterior restorations and are available in 9 main VITA color categories: A1, A3, A4, B1, B3, C1, C3, D2, D4. With the dentin ingots, the technician is able to achieve the highest aesthetic results, comparable to the conventional layering technique.

Ingot	2g #	Price	3g #	Price
<b>AP Volution Z Dentin A1</b>	49840	<b>\$101.59</b>	49851	<b>\$129.34</b>
<b>AP Volution Z Dentin A2</b>	42216	<b>\$101.59</b>	42215	<b>\$129.34</b>
<b>AP Volution Z Dentin A3</b>	49841	<b>\$101.59</b>	49852	<b>\$129.34</b>
<b>AP Volution Z Dentin A4</b>	49843	<b>\$101.59</b>	49853	<b>\$129.34</b>
<b>AP Volution Z Dentin B1</b>	49844	<b>\$101.59</b>	49854	<b>\$129.34</b>
<b>AP Volution Z Dentin B3</b>	49845	<b>\$101.59</b>	49855	<b>\$129.34</b>
<b>AP Volution Z Dentin C1</b>	49846	<b>\$101.59</b>	49856	<b>\$129.34</b>
<b>AP Volution Z Dentin C3</b>	49847	<b>\$101.59</b>	49857	<b>\$129.34</b>
<b>AP Volution Z Dentin D2</b>	49848	<b>\$101.59</b>	49858	<b>\$129.34</b>
<b>AP Volution Z Dentin D4</b>	49849	<b>\$101.59</b>	49859	<b>\$129.34</b>

## Gingiva Ingots

With the Gingiva material it is possible to press pink to the framework followed by press white.

Ingot	2g #	Price	3g #	Price
<b>Metal Gingiva</b>	43002	<b>\$100.81</b>	43003	<b>\$128.53</b>

# Press Over Metal Ingots



## Press & Stain Ingots

For the press & stain technique, the technician can achieve the entire color spectrum with 3 different value based ingots ( light, dark and dark plus ). With one stain cycle, light colors as well as the dark shades can be matched without the use of glaze paste. The feldspar-based porcelain ensures a homogenous natural glaze.

Ingot	2g #	Price	3g #	Price
<b>Metal Classic Light</b>	41102	<b>\$100.81</b>	41103	<b>\$128.53</b>
<b>Metal Classic Dark</b>	41104	<b>\$100.81</b>	41105	<b>\$128.53</b>
<b>Metal Classic Dark Plus</b>	41111	<b>\$100.81</b>	41112	<b>\$128.53</b>
<b>Metal Bleach</b>	41302	<b>\$100.81</b>	41303	<b>\$128.53</b>

## Press & Layer Ingots

The Aesthetic-Press dentin ingots are designed for anterior restorations and are available in 9 main VITA color categories: A1, A3, A4, B1, B3, C1, C3, D2, D4. With the dentin ingots, the technician is able to achieve the highest aesthetic results, comparable to conventional layering.

Ingot	2g #	Price	3g #	Price
<b>Metal Dentin A1</b>	42112	<b>\$100.81</b>	42113	<b>\$128.53</b>
<b>Metal Dentin A3</b>	42217	<b>\$100.81</b>	42214	<b>\$128.53</b>
<b>Metal Dentin A4</b>	42237	<b>\$100.81</b>	42245	<b>\$128.53</b>
<b>Metal Dentin B1</b>	42122	<b>\$100.81</b>	42123	<b>\$128.53</b>
<b>Metal Dentin B3</b>	42238	<b>\$100.81</b>	42246	<b>\$128.53</b>
<b>Metal Dentin C1</b>	42132	<b>\$100.81</b>	42233	<b>\$128.53</b>
<b>Metal Dentin C3</b>	42239	<b>\$100.81</b>	42247	<b>\$128.53</b>
<b>Metal Dentin D2</b>	42142	<b>\$100.81</b>	42243	<b>\$128.53</b>
<b>Metal Dentin D4</b>	42244	<b>\$100.81</b>	42249	<b>\$128.53</b>
<b>Metal High Chroma Bleach</b>	42302	<b>\$100.81</b>	42303	<b>\$128.53</b>

## Volution Z Ingots

With one cycle staining, the silicate reinforced high strength glass ceramics to press over zirconia frames are designed for the Press and Staining Technique. The Aesthetic-Press Volution Bleach ingots are blended with enough opacity to maintain the value in the patient's mouth, but at the same time show enough translucency, so that matching all enamel effects can be easily achieved with the fluorescent AP Stains.

Ingot	2g #	Price	3g #	Price
<b>Volution Z A1</b>	49840	<b>\$98.15</b>	49851	<b>\$124.97</b>
<b>Volution Z A3</b>	49841	<b>\$98.15</b>	49852	<b>\$124.97</b>
<b>Volution Z A4</b>	49843	<b>\$98.15</b>	49853	<b>\$124.97</b>
<b>Volution Z B1</b>	49844	<b>\$98.15</b>	49854	<b>\$124.97</b>
<b>Volution 1 B3</b>	49845	<b>\$98.15</b>	49855	<b>\$124.97</b>
<b>Volution Z Bleach 1</b>	43022	<b>\$98.15</b>	43023	<b>\$124.97</b>
<b>Volution Z Bleach 2</b>	49834	<b>\$98.15</b>	49839	<b>\$124.97</b>
<b>Volution Z Bleach 3</b>	43024	<b>\$98.15</b>	43025	<b>\$124.97</b>

# Stain and Glaze

## Stain Master Kit

Using conventional layering techniques, natural color could only be achieved by the most skilled technicians.

The AP System allows you to recreate those same effects by making the best selection of stains available.

These stains are low fusing and fluorescent paste stains. This paste material can be applied in very thin layers to achieve the most difficult color effects.

Paste stains are recommended for pressable ceramics. The Low Fusing paste stain enables a nice surface texture and shine at 760° C (1400° F).

**Stain Master Kit** Item# 48070 **\$617.77**



## Chroma Stains

With the Chroma Stain shades A,B,C, and D the desired chroma shade can be easily achieved for either the "Classic" or the "Zircon" ingot.



- Chroma A-Shade Stain** 4g Item# 48010 **\$48.82**
- Chroma B-Shade Stain** 4g Item# 48020 **\$48.82**
- Chroma C-Shade Stain** 4g Item# 48030 **\$48.82**
- Chroma D-Shade Stain** 4g Item# 48040 **\$48.82**

## Effect Stains

The effect stains are used to achieve all the natural color effects. These effect stain colors are:

- |        |        |            |
|--------|--------|------------|
| White  | Yellow | Blue       |
| Orange | Brown  | Dark Brown |
| Black  | Grey   | Violet     |



- Black Stain** 4g Item# 48066 **\$47.23**
- Blue Stain** 4g Item# 48064 **\$47.23**
- Brown Stain** 4g Item# 48061 **\$47.23**
- Dark Brown Stain** 4g Item# 48069 **\$47.23**
- Grey Stain** 4g Item# 48063 **\$47.23**
- Orange Stain** 4g Item# 48065 **\$47.23**
- Violet Stain** 4g Item# 48068 **\$47.23**
- White Stain** 4g Item# 48062 **\$47.23**
- Yellow Stain** 4g Item# 48067 **\$47.23**
- Opaquer Light** 7g Item# 46001 **\$47.23**
- Opaquer Dark** 7g Item# 46002 **\$47.23**
- Opaque Bleach** 3g Item# 46003 **\$47.23**

## Margin Stain

The Margin Stain is one of the most useful colors within the stain kit. With the more opacious color, transparent porcelain margins can be covered when using the Pressed to Metal technique.

Margin Stain can very nicely mimic mamelon effects on anterior restorations.

**Margin Stain** 4g Item# 48060 **\$47.23**



## Glaze Paste

The glaze paste is a low fusing material used to glaze veneers or porcelain inlays. This glaze paste leads to great results applied in thin layers, a preheat temperature of 450° C (842° F) and a 6 min dry time. Occasionally, two glaze cycles are recommended.

**Glaze Paste** 4g Item# 48050 **\$47.23**



## Oscar Diamond Polishing Paste

The economical polishing paste for a perfect, soft luster on Zirconia, composite and metal!



**Oscar Diamond Polishing Paste** 30g Item# 49100 **\$73.46**

# Dentures



Relax...

## Megatray is easy to use and easy to form!

Megatray wafers easily forms to models to produce precise-fitting base plates case-after-case. Also use to create fast and easy custom trays. It cures fast and strong with minimal shrinkage. Think Megatray and relax...

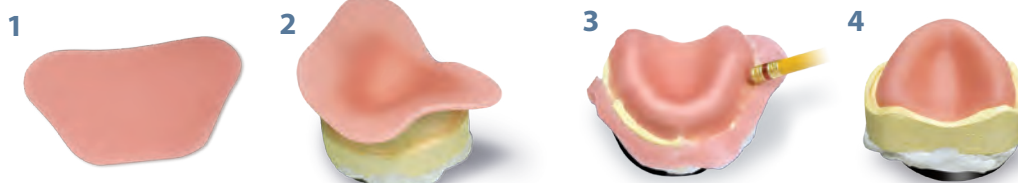

### Megatray Upper (box of 50)

Light curing wafers for custom impression trays and esthetic control baseplates. Unlimited molding time and an easy-to-form consistency.

Megatray Pink - Item# 400-100 **\$79.89 6+ \$74.35**

### Megaclean

Designed specifically for removing the air inhibitor layer on Megatray and is a superb cleaner for lab equipment. Gentle on hands. 300 ml bottle.

Item# 400-101 **\$32.95**

### Mega-I Separator

Alginate separator is used to insulate parts of plaster forms, for denture processing and orthodontics. 500 ml bottle.

Item# 400-102 **\$21.57**

### Mega-Glanz

Liquid polishing agent for high shine on both resins and metals. Use with brush or cloth wheel. 500 ml bottle.

Item# 400-103 **\$27.60**



### Megatray Starter Kit

Contains 30 pink uppers, 100 ml of Megaclean and 100 ml of Mega-I Separator.

Item# 400-104 **\$51.49**

# Articulators

### Crown and Bridge/Denture Articulator

This lightweight articulator is easy to handle yet large enough for denture work. The convenient magnetic base allows for easy removal of the model.

Item# 305-315 **\$34.95**



### Articulating Paper

Double sided red/blue Articulating Paper is used for accurate discrimination between occlusal contacts. The horseshoe shape provides simultaneous bilateral markings to disclose traumatic prematurities of up to .010".

Item# 800-104 **\$3.97 6+ \$3.69**



# Denture Waxes

## Denture Set-up & Carving Wax

This tissue tone wax is used for the construction of the Esthetic Control Base and is most ideal for denture set-ups. The special hardness of this wax lends itself to the fine sculpturing of the denture base while preventing tooth movement. 1 lb box.

Item# 700-112 **\$24.97 6+ \$23.72**



## Bite Wax

This is a peppermint flavored beeswax-type wax for registering intermaxillary relationships. 1 lb box.

Item# 700-113 **\$29.95 6+ \$28.45**

**Provide samples to your doctors. They will love it!**



## RockWax Baseplate Wax

- Strength and stability without brittleness
- Fracture and shatter-resistant
- Hot water softens, room temperature hardens
- Softens in 10 seconds
- Homogenous wax-to-wax bonding, preventing teeth separation
- Great for implants and cases with insufficient room for teeth
- Cost effective, no light-curing necessary
- Compatible with Jet Washer Pro, openless flask boilout system

**Yellow** (1.9 mm, 50 pcs) #RW5019 **\$75.00**



## PTC Stone Separator™

Insulates stone from stone without forming a film. Includes 1 liter bottle with 4 oz. spray applicator.

Item# 600-100 **\$55.35**



# Denture Molds

Practice molds for denture training. Made of durable silicone material, they can be repoured indefinitely without tearing or distortion.

**Male Upper and Lower Mold Set** Item# 205-9110 **\$129.00**

**Female Upper and Lower Mold Set** Item# 205-9120 **\$129.00**

Mounting jigs fit male or female molds and include occlusal plane and midline marks for accurate positioning on articulator.

**Male Mounting Jig** For male upper and lower molds Item# 205-9113 **\$29.95**

**Female Mounting Jig** For female upper and lower molds Item# 205-9123 **\$29.95**



## Denture Instruments

### Rim Former

The rim former is specially designed for reducing bite rims and the Esthetic Control Base. Its unique feature is a raised ledge which fits into the hamular notches of the upper cast. It accurately levels the wax horizontally as the rim is reduced to the incisal edge line. Instructions included.

Item# 305-210 **\$48.95** 6+ **\$44.06**



### Ness Matrix Waxer

This double ended instrument has a heat reservoir on one end that quickly forms natural looking interdental papillae. The other end is a sharp concaved spoon for precision carving. Item# 102-101 **\$69.95**



### Wax Knife

This multi-purpose knife is designed for carrying, softening and cutting wax when setting anterior teeth. The knife end is used to adjust tooth placement.

Item# 102-102 **\$27.20**



### #7 Wax Spatula

This is a double ended spatula. One end is used for the "teardrop" interdental waxing of teeth and the other end is used for carrying large amounts of wax.

Item# 102-103 **\$26.19**



### C.G. Post Dam Carver

Every denture technician has an instrument they have modified in some way to carve a post dam on a working denture cast. We have combined the best qualities of all the modified instruments we have seen into one high quality instrument.

The tempered carving head of the instrument is designed to carve both the 2mm post dam bead at the vibrating line and to feather the cast in the customary butterfly shape. The large handle provides a comfortable grip and enables the technician to easily apply the pressure needed to carve the model. The carving head is gently curved to provide the optimum carving angle.

Item# 102-104 **\$41.20**



## Denture Measuring Instruments

**Save time and money with these simple and easy to use tools.**

PTC's Alameter, Papillameter and Vertimeter provide clear guidelines for technicians to create high quality dentures that require minimal adjustment.

### Alameter

The Alameter is used for selecting the correct size of Personality Molds for the patient. The instrument measures the widest part of the nose at the alae, indicating cuspid-to-cuspid distance (center of cuspid), as it was before edentation. Instructions included.

Item# 300-100 **\$9.67** 10+ **\$8.70**

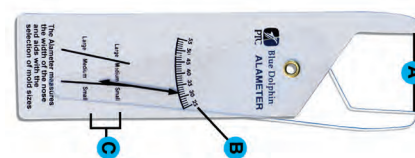

### Cusp Ridge Relator

A device for transferring the position of the lower edentulous ridge crest to the occlusal setup plate.

Item# 314-130 **\$10.95** 10+ **\$8.86**



### Papillameter

A measuring device used in the construction of upper wax rims (Esthetic Control Base). The papillameter measures the vertical distance between the alveolar ridge and the low lip line. A bite rim set at the ideal incisal length for the patient can save the dentist valuable chair time by minimizing adjustments. The papillameter is autoclavable and includes instructions.

Item# 300-102 **\$14.76** 10+ **\$13.28**



### Vertimeter

A convenient measuring instrument used to record vertical dimension and mandibular rest position. Instructions included.

Item# 300-103 **\$9.67** 10+ **\$8.70**



### Bow Compass

Item# 300-104 **\$13.29** 10+ **\$12.10**



### Boley Gauge

Item# 300-105 **\$30.89** 10+ **\$27.80**



### Alma Gauge

Using the Alma Gauge, dentists can measure and record the length and labial position of the anterior teeth as well as posterior tooth position on an existing denture. A clear plastic overlay is used to record the measurements and sent to the lab with the case. The laboratory technician can use the Alma Gauge to duplicate the exact measurements when constructing the Esthetic Control base or relining the denture.

Item# 300-106 **\$89.90**

Fifty (50) sleeves with pen and instructions

Item# 300-107 **\$25.79**



### Alma Bite Plane Gauge

The Alma Bite Gauge is used to determine vertical dimensions in new and existing dentures. It can be used for dot to dot or, reversed for under nose and under chin measurements.

Item# 300-108 **\$57.20**



Steam autoclavable to 134°

### Flexible Ruler (Metric/Inches)

Item# 300-109 **\$3.95**



## Denture Tools

### Micro Torch

Item# 305-601 **\$39.95**

### Butane Refill (1 oz. refill)

Item# 305-603 **\$5.49**

### Pencil Torch PT-130

Item# 305-602 **\$15.49**



### Stippling Burs

Used for stippling dentures. 3 per pack.

Item# 307-120 **\$19.49** 6+ **\$15.49**

## Setup Tools

### Occlusion Control Kit

The Occlusion Control Kit is designed to aid in establishing the occlusal plane and setting the teeth for upper denture setups. Use the Cusp Ridge Relator to transfer the lower ridge to the setup plate. Use the Mould Mate to select anterior teeth molds by determining the width of the upper 6 anterior teeth. Instructions included.

Item# 314-100 **\$32.79**



### Occlusion Control Kit Replacement Components



#### Occlusion Control Plate

Item# 314-110 **\$14.46**



#### Mould Mate

Item# 314-120 **\$9.95**



#### Cusp Ridge Relator

Item# 314-130 **\$10.95**

**Occlusion Control Pen (Black)** Item# 314-140 **\$1.29**

**Occlusion Control Pen (Red)** Item# 314-150 **\$1.29**

### Stainless Steel Template

A stainless steel template .020" thickness. This round disc is used to establish the intermaxillary plane of contact during the set-up of posterior teeth.

Item# 311-120 **\$12.47**



# Intraoral Arch Tracer Ball Bearing Bite Recorder

## Ball Bearing Bite Recorder Kit

The Ball Bearing Bite Recorder Kit is a simple, effective means of obtaining Gothic Arch Tracing. The technique is simple and does not require a preliminary mounting. Therefore, one appointment is eliminated.

Being less bulky than other devices, the BBBR is easier to use and less stressful to the patient. Based on the "ball point pen" principle, the stylus can be incrementally adjusted in the mouth when obtaining vertical. The ball bearing glides smoothly over the tracing plate, leaving an accurate Gothic Arch Tracing.

Even the so-called "locked condyle" patients relax when they are made aware of the smooth rolling ball bearing pin.

Kit includes complete illustrated instruction manual.

Item# 313-100 **\$295.00** 6+ **\$269.49**

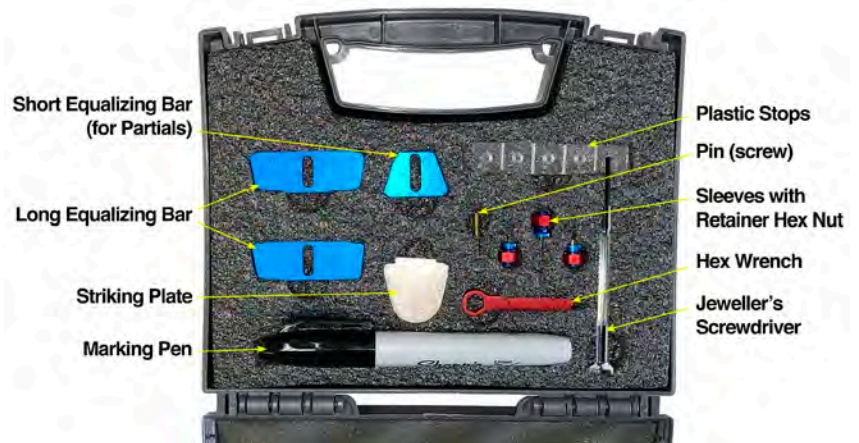

## Ball Bearing Bite Recorder Kit Components

### Long Bar Assembly

Long Bar, Long Screw, Sleeve, Hex Retainer Item# 313-110 **\$69.97**

### Short Bar Assembly

Short Bar, Short Screw, Sleeve, Hex Retainer Item# 313-130 **\$65.79**

**Long Bar** Item# 313-120 **\$22.34**

**Short Bar** Item# 313-140 **\$20.18**

**Sleeve** Item# 313-150 **\$14.39**

**Hex Retainer Nut** Item# 313-160 **\$10.25**

**Short Screw with Ball Bearing Head** Item# 313-190 **\$21.69**

**Long Screw with Ball Bearing Head** Item# 313-180 **\$26.95**

**Stops (Strip of 5)** Item# 313-200 **\$15.95**

**Contoured Striking Plate** Item# 313-210 **\$10.80**

**Hex Retainer Wrench** Item# 313-170 **\$20.55**

**Marking Pen** Item# 313-220 **\$2.25**

**Jeweler's Screwdriver** Item# 313-230 **\$6.95**

**Instruction Manual** Item# 313-260 **\$29.95**

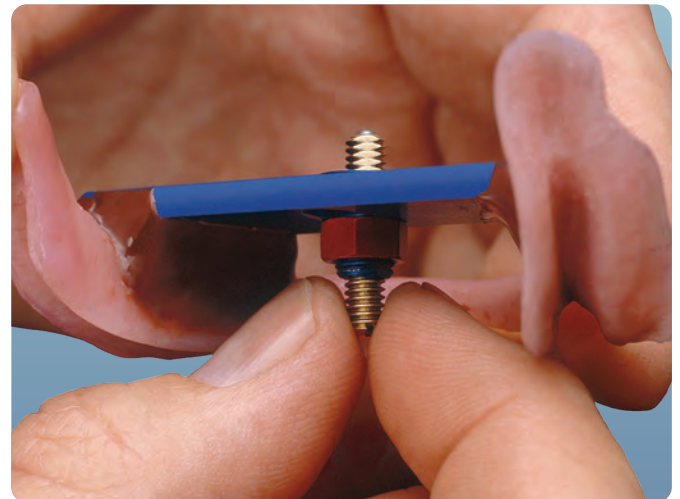



# Denture Processing

Snow Rock affordable injection system and materials are the perfect choice for every laboratory or dental office that values speed efficiency and quality. The JetPAC Hybrid Kit (A) provides everything you need to create full dentures, flexible and semi flexible partials, flippers, night guards, etc.

Snow Rock's full range of acrylics and thermoplastics are known for lifelike esthetics, exceptional strength and durability. If you are just starting or have high production demand, this system is for you.



## JetPAC Hybrid Injector (A)

Injector compatible with JetPAC hybrid flask and jet flask. • Full Dentures, Flexibles, Flippers, Metal, Metal-Free, and Partial • The affordable, most innovative denture system • Free to inject a new case every 45 sec, without limit • Operates via compressed air • Simple lever operation • Compact design **Item# J001 \$4,449.00**



## Jet Furnace Duo (B)

Melts 6 cases simultaneously with two temperature zones. **Item# E012 \$3,499.00**



## Jet Washer Pro (C)

Fully automatic steam boilout tank. • Remove 100% Wax From 6 Snow Rock Flasks w/ One Button Touch • Dewax 15 Non-Snow Rock Flasks Traditionally • Sanitary and Efficient Steam, No Drain Clog or Boiling Water **Item# E0004 \$10,999.00**



## Jet Flask plus Flexible Cylinder Set (D)

Jet standard thermoplastic flask with flexible cylinder. • 1 Jet flask • 1 Flexible cylinder • 1 Flexible cylinder disk **Item# K101AKS \$329.00**



## Jet Flask plus Heat-Cure Cylinder Set (E)

Jet standard thermoplastic flask with heat-cure cylinder. • 1 Jet flask • 1 Heat-cure cylinder • 1 Heat-cure cylinder disk **Item# K001/2AKS \$329.00**



## JetPAC Hybrid Kit A (F)

Inject heat-cure plus thermo-flexible resin. • JetPAC Hybrid Injector • Moisture Filter • Jet Furnace Duo • 4 - Jet Flask • 2 - Flexible Cylinder • 2 - Flexible Cylinder Nugget • Flexible Pressurization Bar • Flexible Removal Stand Set • 2 - Heat-Cure Cylinder • 2 - Heat-Cure Cylinder Nugget • 2 - Heat-Cure Pressurization Bar • 3 - Shade Guides • 3 - Sprue Wax (4mm, 5.5mm, 7.5mm) • Check Valve • Sulfon Packing • AcryFlex, FlexFit, QuickBase Samples • Accessories (Plier, Hammer, Hex Wrench, Tube, Connector, Seals, Etc) • Snow Rock Manual **Item#K001 \$8,499.00**



## JetPAC Hybrid Kit B (G)

Inject heat-cure resin. • JetPAC Hybrid • Moisture Filter • 2 - Jet Flask • 2 - Heat-Cure Cylinder • 2 - Heat-Cure Cylinder Nugget • 1 - Heat-Cure Pressurization Bar • Extra Seal Rings • 3 - Sprue Wax (4mm, 5.5mm, 7.5mm) • Check Valve • Sulfon Packing • QuickBase Samples • Accessories (Hammer, Hex Wrench, Tube, Connector, Seal, Etc) • Snow Rock Manual **Item#K002 \$4,899.00**



### HardPour Pourable Acrylic

High-impact pourable acrylic. Highest impact strength and quality pourable on the market. Excellent liquid-like flowability, extremely easy to handle and pour. Top thermal color stability. Fits better than the leading competitor. Fantastic esthetics, available in standard shades.



Shade	1 lb powder + 8 oz liquid	5 lb powder + 1 qt liquid	25 lb powder + 1 gal liquid
Clear	HP5382AA \$104	HP5382BB \$418	HP5382CC \$1760
Original	HP5383AA \$104	HP5383BB \$418	HP5383CC \$1760
Light	HP5384AA \$104	HP5384BB \$418	HP5384CC \$1760
Light Red-Pink	HP5385AA \$104	HP5385BB \$418	HP5385CC \$1760
Dark Pink	HP5386AA \$104	HP5386BB \$418	HP5386CC \$1760
Light Red-Orange	HP5387AA \$104	HP5387BB \$418	HP5387CC \$1760

### QuickBase Denture Base Resin

Heat-cure acrylic denture base resin. Just 10 minute cure in boiling water, 20 minute bench cool. High impact strength and quality. Zero porosity. Available in 9 shades. Conventional pack or injection.



Shade	1 lb powder + 8 oz liquid	5 lb powder + 1 qt liquid	25 lb powder + 1 gal liquid
Clear	QB5382AA \$65	QB5382BB \$275	QB5382CC \$975
Original	QB5383AA \$65	QB5383BB \$275	QB5383CC \$975
Light	QB5384AA \$65	QB5384BB \$275	QB5384CC \$975
Light Red-Pink	QB5385AA \$65	QB5385BB \$275	QB5385CC \$975
Dark Pink	QB5386AA \$65	QB5386BB \$275	QB5386CC \$975
Light Red-Orange	QB5387AA \$65	QB5387BB \$275	QB5387CC \$975
Mild Red	QB5388AA \$65	QB5388BB \$275	QB5388CC \$975
Mild Dark Pink	QB5389AA \$65	QB5389BB \$275	QB5389CC \$975

### AcryFlex Acrylic

Semi-flexible thermo-acrylic that brings the workability of an acrylic material to the creation of any type of application, including flexible partials. Safe and monomer free.



Shade	5 pack small 25mm cartridge	5 pack medium 25mm cartridge	5 pack large 25mm cartridge
Clear	AF5590S \$30	AF5590M \$40	AF5590L \$45
Clear Pink	AF5591S \$30	AF5591M \$40	AF5591L \$45
Light Pink	AF5592S \$30	AF5592M \$40	AF5592L \$45
Pink	AF5593S \$30	AF5593M \$40	AF5593L \$45
Live Pink	AF5595S \$30	AF5595M \$40	AF5595L \$45
Real Pink	AF5597S \$30	AF5597M \$40	AF5597L \$45
Dark Pink	AF5598S \$30	AF5598M \$40	AF5598L \$45
Clear		1 kg bag AF5590 \$249	10 kg bag AF5590B \$2290
Clear Pink		AF5591 \$249	
Light Pink		AF5592 \$249	
Pink		AF5593 \$249	
Live Pink		AF5595 \$249	
Real Pink		AF5597 \$249	AF5597B \$2290
Dark Pink		AF5598 \$249	

### ClearFit Polyamide

Translucent flexible polyamide. Glass-like clarity. Excellent esthetic finish without special burs. Lab repairable. Relineable with any soft reliner. Monomer free and 100% hypoallergenic.



5-pk small 25mm cartridge	CF5145S \$30.00
5-pk medium 25mm cartridge	CF5145M \$42.50
5-pk large 25mm cartridge	CF5145L \$47.50
1kg bag	CF5145 \$265.00
10kg bag	CF5145B \$2,399.00

### FlexFit Nylon

Flexible thermo-nylon for fully flexible partials and clasps. FlexFit is slightly more flexible than AcryFlex, which allows it to be made extremely thin and is useful in cases with difficult paths of insertion. Lab repairable. Fully relineable with any soft reliner. Monomer free and 100% hypoallergenic.



Shade	5 pack small 25mm cartridge	5 pack medium 25mm cartridge	5 pack large 25mm cartridge
Original	AF5184S \$30.00	AF5184M \$40.00	AF5184L \$45.00
Clear Pink	AF5181S \$30.00	AF5181M \$40.00	AF5181L \$45.00
Light Pink	AF5182S \$30.00	AF5182M \$40.00	AF5182L \$45.00
Pink	AF5183S \$30.00	AF5183M \$40.00	AF5183L \$45.00
Real Pink	AF5144S \$30.00	AF5144M \$40.00	AF5144L \$45.00
Dark Pink	AF5133S \$30.00	AF5133M \$40.00	AF5133L \$45.00
Original		1 kg bag AF5184 \$265.00	10 kg bag AF5184B \$2,290.00
Clear Pink		AF5181 \$265.00	
Light Pink		AF5182 \$265.00	
Pink		AF5183 \$265.00	
Real Pink		AF5144 \$265.00	
Dark Pink		AF5133 \$265.00	

### TurboFix Base Set

Gingiva-shaded self-cure repair acrylic. 3.5 oz powder and 1.7 fl oz liquid.

Clear	TF5450S \$99.00	Clear Pink	TF5452S \$99.00
Light Pink	TF5454S \$99.00	Pink	TF5456S \$99.00
Live Pink	TF5460S \$99.00	Real Pink	TF5463S \$99.00
Original	TF5483S \$99.00	Light Pink	TF5484S \$99.00
Dark Pink	TF5486S \$99.00		



### TurboFix Tooth Set

Tooth-shaded self-cure repair acrylic. 3.5 oz powder and 1.7 fl oz liquid.

#A1	TF5471S \$73.00
#A2	TF5472S \$73.00
#A3	TF5473S \$73.00
#Incisal	TF5474S \$73.00



### ResinSep Separator

Premium denture resin separator. RS1510 \$39.99



# PTC Training App



**PTC**  
**DIGITAL**

Designed for both  
new CAD CAM  
technicians and  
experienced  
technicians



## Terms

- A. All orders prepaid by credit card.
- B. VISA, MasterCard, and American Express are accepted.
- C. After five orders customers may apply for credit terms.
- D. All credit terms are Net 30 days.
- E. All orders are subject to shipping and handling charges.
- F. All prices are in U.S. funds. Prices are subject to change without notice.
- G. There is a minimum order amount of \$25.00.

## Returns

- A. Please contact our Materials Manager prior to the return of any goods to our office.
- B. All returns must be authorized to assure proper credit of your account.
- C. All returns are subject to a 15% restocking fee.
- D. There is a 15% restocking charge on all returns received without pre-approved return authorization or on returns past 30 days of invoicing.

## Damages

- A. If your package(s) arrive damaged, note in writing the extent of damage on delivery bill i.e. carton(s) wet, crushed, torn, hole in carton, carton rattles, etc.)
- B. If damage is discovered after delivery:
  - a. Retain all merchandise, cartons, and packing materials for inspection.
  - b. Notify local office or carrier (U.P.S. or motor freight) and request an inspection.
  - c. This initial request may be verbal, but must be confirmed in writing.

To place an order or if you have any questions on the above please contact our Customer Service department at:

800.448.8855 direct: 408.776.0433 fax: 408.776.0145 contact@bdpdental.com  
online at [www.bdpdental.com](http://www.bdpdental.com)



**Blue Dolphin  
Products™**

**TO ORDER**  
800.448.8855

**DENTAL SUPPLIES**  
[bdpdental.com](http://bdpdental.com)

**DENTAL LAB TRAINING**  
[ptcdental.com](http://ptcdental.com)